

Stamp
here



Organized by

Association of
Private Medical Specialists
of Hong Kong

Co-organizers



The Society of
Anaesthetists
of Hong Kong



Hong Kong
Society of
Breast Surgeons



The Hong Kong
Cancer Therapy
Society



Hong Kong
College of
Cardiology



Hong Kong
Society of
Clinical Oncology



Hong Kong
Society for
Coloproctology



Hong Kong
Society of
Critical Care
Medicine



The Hong Kong
Society of
Diagnostic
Radiologists



Hong Kong
Society of
Endocrinology,
Metabolism and
Reproduction



The Hong Kong
Society of
Gastroenterology



The Hong Kong
Geriatrics
Society



The Hong Kong
Society of
Haematology



Hong Kong
IBD
Society



The Hong Kong
Society for
Infectious
Diseases



The Hong Kong
Society of
Interventional
Radiology



Hong Kong
Association for
the Study of
Liver Diseases



The Hong Kong
Medical
Association



Hong Kong
Society of
Medical Genetics



Hong Kong
Society of
Minimal Access
Surgery



The Hong Kong
Neurosurgical
Society



The
Obstetrical and
Gynaecological
Society of Hong Kong



Hong Kong
Ophthalmological
Society



The Hong Kong
Association of
Oral and Maxillofacial Surgeons



The Hong Kong
Orthopaedic
Association



The
Osteoporosis
Society of Hong Kong



Hong Kong Society of
Otorhinolaryngology,
Head & Neck Surgery



Hong Kong
Society of
Palliative Medicine



The Hong Kong Society of
Plastic, Reconstructive and
Aesthetic Surgeons



The Hong Kong
Society of
Psychiatrists



Hong Kong
Public Doctors'
Association



Hong Kong
Association of
Rehabilitation
Medicine



The Hong Kong
Society of
Rheumatology



Hong Kong Society of
Upper
Gastrointestinal
Surgeons



Hong Kong
Urogynaecology
Association



Hong Kong
Urological
Association

www.mmmcon.com

MIC³ 2013



**MULTI-SPECIALTY
MEDICAL MEGA
CONFERENCE 2013
13-14 April**

Ball Room | Langham Place Hotel | Mongkok

Registration fee

HK\$200 | Member of all Organizing Societies

HK\$400 | Non-member

HK\$200 | Nursing Colleagues & Allied Health Professionals

Multi-specialty Content

Excellent Quality

Great Faculty

All Doctors Welcome

CME, CPD & CNE accredited

For registration and detailed programme, please visit:

www.mmmcon.com

Enquiry

Ms May Cheung

Email | info@mmmcon.com

MULTI-SPECIALTY
MEDICAL
MEGA CONFERENCE 2013



13-14 April 2013

Ball Room | Langham Place Hotel | Mongkok

Organizing Committee

Dr KWOK Po Yin, Samuel *Chairman*

Dr CHAN Chong Pun, Ben
Dr CHAN Chor Man
Dr CHAN Chun Kwong, Jane
Dr CHAN Hei Ling, Helen
Dr CHAN Kuen Ting
Dr CHAN Wai Kong
Dr CHAN Wing Wai, Sharon
Dr CHAN Yu Leung, Walter
Dr CHENG Hung Fai, David
Dr CHENG Sung Ko, Charles
Dr CHEON Willy, Cecilia
Dr CHEUNG Yui Shan, Hester
Dr CHIU Sau Hin, Sonny
Dr CHO Hing Yan, Danny
Dr CHOW Chun Kuen
Dr CHOW Lop Keung, Raymond
Dr CHOW Wing Sun
Dr CHUN Siu Yeung
Dr FOO Kam So, Stephen
Dr FOO Wai Lum, William
Dr FU Kam Fung, Kenneth
Dr FUNG Tat Chow, Berry
Dr GO Wing Wa
Dr HO Kai Leung, Kelvin
Dr HO Sheung Tung
Dr HO Yiu Yan, Andrew
Dr HUI Yee Tak
Dr KWOK Kam Hung
Dr KWOK Kwan Ho
Dr LAI Cham Fai
Dr LAI Sik To

Dr LAM Kui Chun
Dr LAM Po Tin
Dr LAO Wai Cheung
Dr LEE Fook Kay, Aaron
Dr LEE Ka Wing, Gavin
Dr LEE Kin Hung
Dr LEE Kin Yip, Philip
Dr LEUNG Ping, Maurice
Dr LI Ching Fan, Carina
Dr LI Kwok Tung, Donald
Dr LING Yu Kong, John
Dr LO Fai Man, Ivan
Dr LO Richard
Dr MAK Ying Fai
Dr PONG Chiu Fai, Jeffrey
Dr SIU Wing Tai
Dr SO Man Kit, Thomas
Dr TAN Song Tuen
Dr TSANG Fan Kwong
Dr TSANG Wing Hang, Janice
Dr TSE Tak Fu
Dr WONG Kin Hung, Simon
Dr WONG Kwok Yiu, Chris
Dr WONG Sau Yan, David
Dr WONG Yee Hang, Birgitta
Dr WONG Yee Him, John
Dr YAM Kwong Yui
Dr YAN Wing Wa
Dr YEUNG Yuk Pang, Philip
Dr YUEN Shi Yin, Nancy

Welcome Message



It is my great pleasure to present to you the third **Multi-specialty Medical Mega Conference** to be held on 13 - 14 April 2013 at the Langham Hotel Mongkok. To ride on the success of the last two conferences and with the conjoint effort of thirty-six medical societies, around one hundred topics which cover almost all specialties were organized into a comprehensive and informative program. The beauty of the multispecialty program is that one can not only update on development of your own specialty but also keep abreast on knowledge from other specialties and is very often the most interesting experience according to many participants. This year we have 24 themed sessions on various specialty subjects arranged in four parallels over the two days of conference. There is also one special debate session on Medical Manpower which is a highly controversial subject that seems to haunt the medical field forever.

You are therefore most welcome to participate in this conference. Join this great annual medical event and share the fun of updating knowledge, contributing your views, and meeting your colleagues all at the same time. Please do not miss this once a year opportunity and register now for the conference.

Dr KWOK Po Yin, Samuel
Conference Chairman

13-14 April 2013

Ball Room | Langham Place Hotel | Mongkok

Floor Plan

Level 8

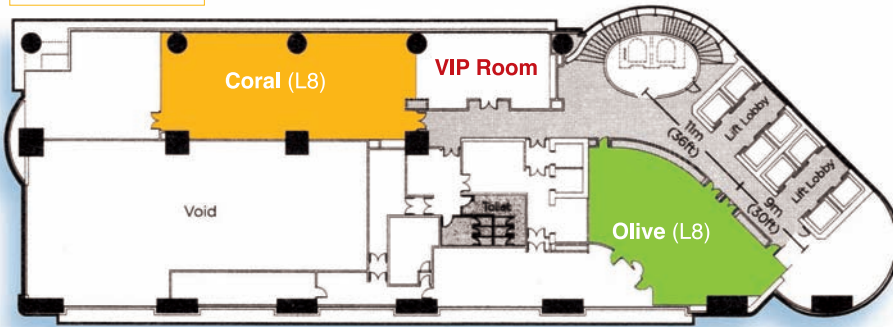

Level 7

Ball Room Level

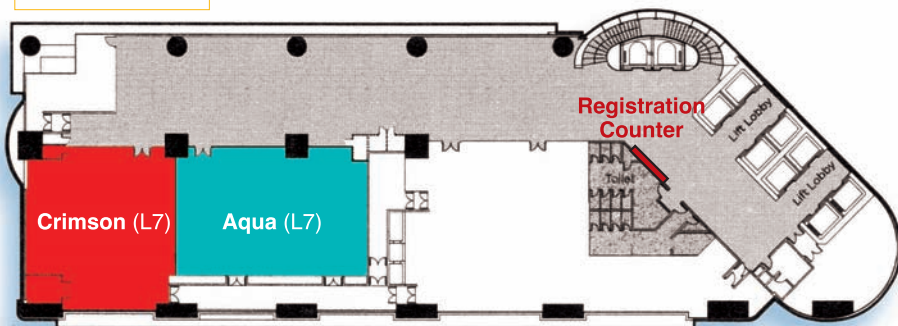

13 April 2013 PM (Saturday) Tentative Programme

1300 - 1330 Registration & Light Refreshment (Level 7)					
Session	Heart 2013 & Forward	Update in Breast Cancer Management	Eye and Body	Critical Care & Resuscitation	
1330 - 1500	1330-1350 Heart safe school project Dr WONG Kwok Yiu, Chris	1330-1347 When to use neoadjuvant systemic therapy for breast cancer patient? Dr YAU Tsz Kok	1330-1350 Diabetes and eye Dr CHAN Wai Nang, Clement	1330-1350 Extracorporeal cardiopulmonary resuscitation (eCPR) for Marathon Runner Dr CHAN King Chung, Kenny	
	1350-1410 Mitral clip for MVP Dr KO Lap Yan, Ryan	1347-1404 Update in Sentinel lymph node biopsy Dr LAM Yeung Kit, Billy	1350-1410 Eye manifestations of neurologic conditions Dr CHAN Carmen	1350-1410 Post-cardiac arrest care Dr CHAN Yan Fat, Alfred	
1500 - 1530	1410-1430 Stroke prevention in AF by new anticoagulants and left atrial appendage occlusion Dr YIP Wai Kwok, Gabriel	1404-1421 Assessment of surgical margin in breast cancer specimen Dr NG Wai Kuen	1410-1430 Paediatric eye problem that you don't want to miss Dr KO Tak Chuen, Simon	1410-1430 Ethical issues in end-of-life care in intensive care setting Dr TSE Chun Yan	
	1430-1450 Renal denervation for hypertension and beyond Dr CHENG Cheung Wah, Boron	1421-1438 Modern role of RT in breast cancer management Dr FOO Wai Lum, William	1430-1450 Glaucoma-advances in diagnosis and systemic associations Dr YUEN Shi Yin, Nancy	1430-1450 Update in continuous renal replacement therapy (CRRT) Dr YAN Wing Wa	
1450 - 1500	1438-1455 RT and breast reconstruction: which first? Dr WONG Sau Yan, David	Tea Break (Levels 7 & 8)			
Session	Dialysis in Community	Ambulatory Care	Multidisciplinary Approach in Osteoporosis	Emerging Infections	
1530 - 1700	1530-1550 New models of hemodialysis in Hong Kong Dr TONG Kwok Lung, Matthew	1530-1550 Office setting for ambulatory patients - 10 years experience in a referral-based specialist practice in Hong Kong Dr CHOW Kwok Fai, James	1530-1555 Optimizing bone health with diet Ms YEUNG Emily	1530-1550 Emerging infections near the door Dr CHAN Jacky	
	1550-1610 Pitfalls in AV fistula Dr LEONG Che Hung	1550-1610 Safe sedation in an office setting Dr LOW John	1555-1620 Pitfalls in the interpretation of DXA scan Dr CHEUNG Shing Kee, William	1550-1610 Medical advice for exotic travel Dr WONG Bonnie	
1700 - 1715	1610-1630 PD - the pros and cons Professor LI Kam Tao, Philip	1610-1630 Ambulatory care in eye surgery patients with medical problems Dr YU Derek	1620-1645 Medical treatment of osteoporosis: right patient, right drug and right time Dr HO Yiu Yan, Andrew	1610-1630 The local scene of invasive candidiasis Dr WONG Elsa	
	1630-1650 Cardiological complications in patients with end stage kidney diseases Professor TANG Sydney	1630-1650 Office base ENT, head & neck procedure - Doing it safely Dr SOO Gordon	Break		
1715 - 1800 Plenary Session (Level 8) Medical Manpower - Beyond demand and supply (A debate)					
1715 - 1800	Chairpersons: Dr LEE Fook Kay, Aaron & Dr PONG Chiu Fai, Jeffrey Speakers: Dr KO Wing Man (Secretary for Food and Health Bureau) Dr the Honourable LEUNG Ka Lau (Member of Legislative Council) Dr AU Kit Shing, Derrick (Head of Human Resources, Hospital Authority) Dr KWOK Po Yin, Samuel (Chairman of Professional Affairs, Association of Private Medical Specialists of Hong Kong) Dr TSE Hung Hing (President, Hong Kong Medical Association) Dr FU Kam Fung, Kenneth (President, Hong Kong Public Doctors' Association) Professor FOK Tai Fai (Vice President (General Affairs), Hong Kong Academy of Medicine) Dr CHEUNG Hon Ming (President, The Association of Licentiate of Medical Council of Hong Kong)				
1800	Cocktails & Faculty Banquet (Star Room, Level 42)				
	Crimson (L7)	Aqua (L7)	Coral (L8)	Olive (L8)	

14 April 2013 AM (Sunday) Tentative Programme

0900 - 0930 Registration & Light Refreshment (Level 7)				
Session	Auto-immune Diseases	Challenges in Coloproctology	Face Changes	Management of Malignant Brain Tumour
0930 - 1100	0930-0950 SLE - update on therapeutic strategies Dr CHAU Shuk Yi, Lucia	0930-0950 Update on use of biologics for IBD in HK Professor LEUNG Wai Keung	0930-0950 Orthognathic correction of dentofacial deformities Dr LEE Kin Man, Philip	0930-0947 Primary malignant brain tumour Dr TAN Tze Ching
	0950-1010 Recognizing autoimmune skin diseases Dr CHIU Lai Shan, Mona	0950-1010 Stapled haemorrhoidectomy: controversies, technical concerns and common pitfalls Dr TSE Cyrus	0950-1010 Face changing surgery for patients with craniofacial syndromes Dr HO Lai In, Jeni	0947-1004 Metastatic brain tumour Dr HUNG Wai Man
	1010-1030 Case studies on systemic vasculitis - a diagnosis not to be missed Dr YU Ka Lung, Carrel	1010-1030 Updated management of complicated cryptoglandular anal fistula Dr LO Oswens	1010-1030 Maxillofacial prosthesis Dr TAM Stephen	1004-1021 Surgical treatment of malignant brain tumour Dr LEE Wing Yan, Michael
1100 - 1130	1030-1050 Lessons learnt in the anti-cytokine therapies in rheumatic diseases Dr LEE Ka Wing, Gavin	1030-1050 Diagnosis and management of faecal incontinence Professor MAK Yiu Kei, Antony	1030-1050 Outcomes of surgical correction of dentofacial deformities Dr LEUNG Mike	1021-1038 Adjuvant therapy for malignant brain tumour Dr YAU Stephen
	1100 - 1130 Tea Break			
	1130-1150 Stem cells in cardiology Professor TSE Hung Fat	1130-1150 Premature ejaculation and infertility Dr MAK Siu King	1130-1150 Glycaemic control and macro-vascular complications Dr YEUNG Chi Kin	1130-1150 Endocrine and metabolic diseases in pregnancy Dr LAU Emmy
1130 - 1300	1150-1210 Stem cell therapy in haematology Professor LEUNG Yu Hung, Anskar	1150-1210 Male sexual transmitted disease Dr HO King Man	1150-1210 Management of lower limb ischaemia Dr CHIU Kai Ming, Leo	1150-1210 Abdominal pain - A surgeon's perspective Dr CHUNG Chi Chiu, Cliff
	1210-1230 Use of mesenchymal stem cells Professor CHAN Chi Fung, Godfrey	1210-1230 How to approach lady with vaginal discharge and pain? Dr MAK Ho Leung, Jimmy	1210-1230 Endovascular treatment in critical ischaemia Dr CHIU Sau Hin	1210-1230 Critical care in pregnancy Dr LAI Kang Yiu
	1230-1250 Cord blood transplant for children Dr LEE Vincent	1230-1250 Andropause: Should be checked? Should we replace? How? Dr LEE Ka Kui	1230-1250 Lower limb gangrene: What are the options? Dr YIP Siu Fai, Henry	1230-1250 Mood disorders in pregnancy (TBC)
1300 - 1400 Lunch				
<div style="display: flex; justify-content: space-between;"> Crimson (L7) Aqua (L7) Coral (L8) Olive (L8) </div>				

14 April 2013 PM (Sunday) Tentative Programme

Session	Mind and Brain (Lundback Session)	Minimally Invasive Therapy	Paediatric Lower Limb - Gait Disturbance in Children	Recent Advances of Upper GI Cancer in the 21st Century
1400 - 1530	1400-1440 Medicine of depression and happiness Professor TANG Siu Wa	1400-1420 Updated management of GERD Dr WONG Chun Yu, Benjamin	1400-1420 Common neurological problems in paediatric lower limbs Dr WU Shun Ping	1400-1420 Recent advances in upper GI cancer Dr LEE Tai Yam, Daniel
	1440-1520 Brain body connection : Somatic symptoms re-visited Dr WONG David	1420-1440 The new trend - colonic ESD Dr LEE Ha Man, Vivian	1420-1440 Common orthopaedic problems in paediatric lower limbs Dr WONG Man Shun, George	1420-1440 Latest update on treatment of esophageal cancer Professor KWAN Dora
	1530 - 1600	1440-1500 Changing paradigm - minimal invasive vascular surgery Dr TSE Cheuk Wah	1440-1500 Arthritis in children Dr LEE Tsz Leung	1440-1500 Towards personalized management for gastric cancer Dr KWAN Wing Hong
1500-1520 Robotic Surgery - current updates Dr YAU Kwok Kay, Kevin		1500-1520 Management of spasticity in children Dr LAW Hing Yuen, Dickson	1500-1520 Reflection on palliative care for advanced cancer Dr YEUNG Rebecca	1500-1520 Reflection on palliative care for advanced cancer Dr YEUNG Rebecca
1530 - 1600 Tea Break				
1600 - 1730	1600-1620 Difficult to treat asthma Dr LEUNG Chung Chuen, Roland	1600-1617 Characterization of liver lesions in cirrhotic patients Dr LOKE Kwok Loon, Tony	1600-1617 Exercise for patients with chronic diseases Dr MA Hon Ming, Ernest	1600-1620 Genomic technology Professor SHAM Pak Chung
1600 - 1730	1620-1640 Skin test in allergy Dr LEE Tak Hong	1617-1634 Multidisciplinary management of colorectal liver metastasis Dr FUNG Ting Pong	1617-1634 Exercise after fragility fracture Dr LAM Chor Yin	1620-1640 Proton therapy Dr CHUA Tsin Tien, Daniel
	1640-1700 Allergy and genes for the uninitiated Dr LEUNG Ting Fan	1634-1651 Interventional radiology in the management of liver tumours Dr FUNG Dickson	1634-1651 Care of disable in sports Dr WONG Ping San, John	1640-1700 Perfusion imaging in acute stroke Dr POON Wai Lun, William
	1700-1720 Cofactors in food allergy Dr CHAN Hei Ling, Helen	1651-1708 HBV treatment and hepatocellular carcinoma Dr WONG Lai Hung, Grace	1651-1708 Return to sport after injury Dr YAU Wai Pan, Peter	1700-1720 Upcoming technology in robotic surgery Professor POON Carmen
1730	1708-1725 Updates on medical treatment for HCC Professor YEO Winnie	1708-1725 Emergency sports medicine Dr WU Wing Cheung, Kenneth	1708-1725 Emergency sports medicine Dr WU Wing Cheung, Kenneth	
	1730 End of Programme			
<div style="display: flex; justify-content: space-between;"> Crimson (L7) Aqua (L7) Coral (L8) Olive (L8) </div>				

Diamond sponsor: _____



Your Vision, Our Future

Platinum sponsors: _____



Golden sponsors: _____



Bauhinia sponsors: _____



Other sponsors: _____



By fax : 2899 2267 (Attn: May Cheung)
 By E-mail : registration@mmmcon.com
 By Mail : 4/F., 9 Queen's Road Central, Central, Hong Kong (Attn: May Cheung)

I would like to register for the M³C:-

Name : (In Block Letters) _____
 Post : _____
 Institution / Organization : _____
 Tel : _____ Email : _____
 Address : _____

I am member of one of the following organizations.

(Please ✓ as appropriate)

- | | |
|--|--|
| <input type="checkbox"/> The Society of Anaesthetists of Hong Kong | <input type="checkbox"/> Hong Kong Society of Medical Genetics |
| <input type="checkbox"/> Hong Kong Society of Breast Surgeons | <input type="checkbox"/> Hong Kong Society of Minimal Access Surgery |
| <input type="checkbox"/> The Hong Kong Cancer Therapy Society | <input type="checkbox"/> The Hong Kong Neurosurgical Society |
| <input type="checkbox"/> Hong Kong College of Cardiology | <input type="checkbox"/> The Obstetrical and Gynaecological Society of Hong Kong |
| <input type="checkbox"/> Hong Kong Society of Clinical Oncology | <input type="checkbox"/> Hong Kong Ophthalmological Society |
| <input type="checkbox"/> Hong Kong Society for Coloproctology | <input type="checkbox"/> The Hong Kong Association of Oral and Maxillofacial Surgeons |
| <input type="checkbox"/> Hong Kong Society of Critical Care Medicine | <input type="checkbox"/> The Hong Kong Orthopaedic Association |
| <input type="checkbox"/> The Hong Kong Society of Diagnostic Radiologists | <input type="checkbox"/> The Osteoporosis Society of Hong Kong |
| <input type="checkbox"/> Hong Kong Society of Endocrinology, Metabolism & Reproduction | <input type="checkbox"/> Hong Kong Society of Otorhinolaryngology, Head & Neck Surgery |
| <input type="checkbox"/> The Hong Kong Society of Gastroenterology | <input type="checkbox"/> Hong Kong Society of Palliative Medicine |
| <input type="checkbox"/> The Hong Kong Geriatrics Society | <input type="checkbox"/> The Hong Kong Society of Plastic, Reconstructive and Aesthetic Surgeons |
| <input type="checkbox"/> The Hong Kong Society of Haematology | <input type="checkbox"/> The Hong Kong Society of Psychiatrists |
| <input type="checkbox"/> Hong Kong IBD Society | <input type="checkbox"/> Hong Kong Public Doctors Association |
| <input type="checkbox"/> The Hong Kong Society for Infectious Diseases | <input type="checkbox"/> Hong Kong Society of Rehabilitation Medicine |
| <input type="checkbox"/> The Hong Kong Society of Interventional Radiology | <input type="checkbox"/> The Hong Kong Society of Rheumatology |
| <input type="checkbox"/> Hong Kong Association for the Study of Liver Diseases | <input type="checkbox"/> Hong Kong Society of Upper Gastrointestinal Surgeons |
| <input type="checkbox"/> The Hong Kong Medical Association | <input type="checkbox"/> Hong Kong Urogynaecology Association |
| | <input type="checkbox"/> Hong Kong Urological Association |

I enclose herewith a cheque of

HK\$200 (Member of any one of the above named organizations) /

HK\$400 (Non-member) /

HK\$200 (Nursing Colleagues & Allied Health Professionals)

Payable to "Association of Private Medical Specialists of Hong Kong Ltd."

Cheque No. : _____ Issuing Bank : _____

Date : _____

Stamp
here

MULTI-SPECIALTY
MEDICAL
MEGA CONFERENCE 2013

4/F., 9 Queen's Road Central,
Central, Hong Kong
Attn: May Cheung



Enquiry

Ms May Cheung

Email | info@mmmcon.com

www.mmmcon.com

MULTI-SPECIALTY
MEDICAL
MEGA CONFERENCE



13-14 April 2013

Ball Room | Langham Place Hotel | Mongkok